

6750

ADJOINING BLOCK

ADJOINING BLOCK

PLAN EXISTING COLD STORAGE AT MUMBAI

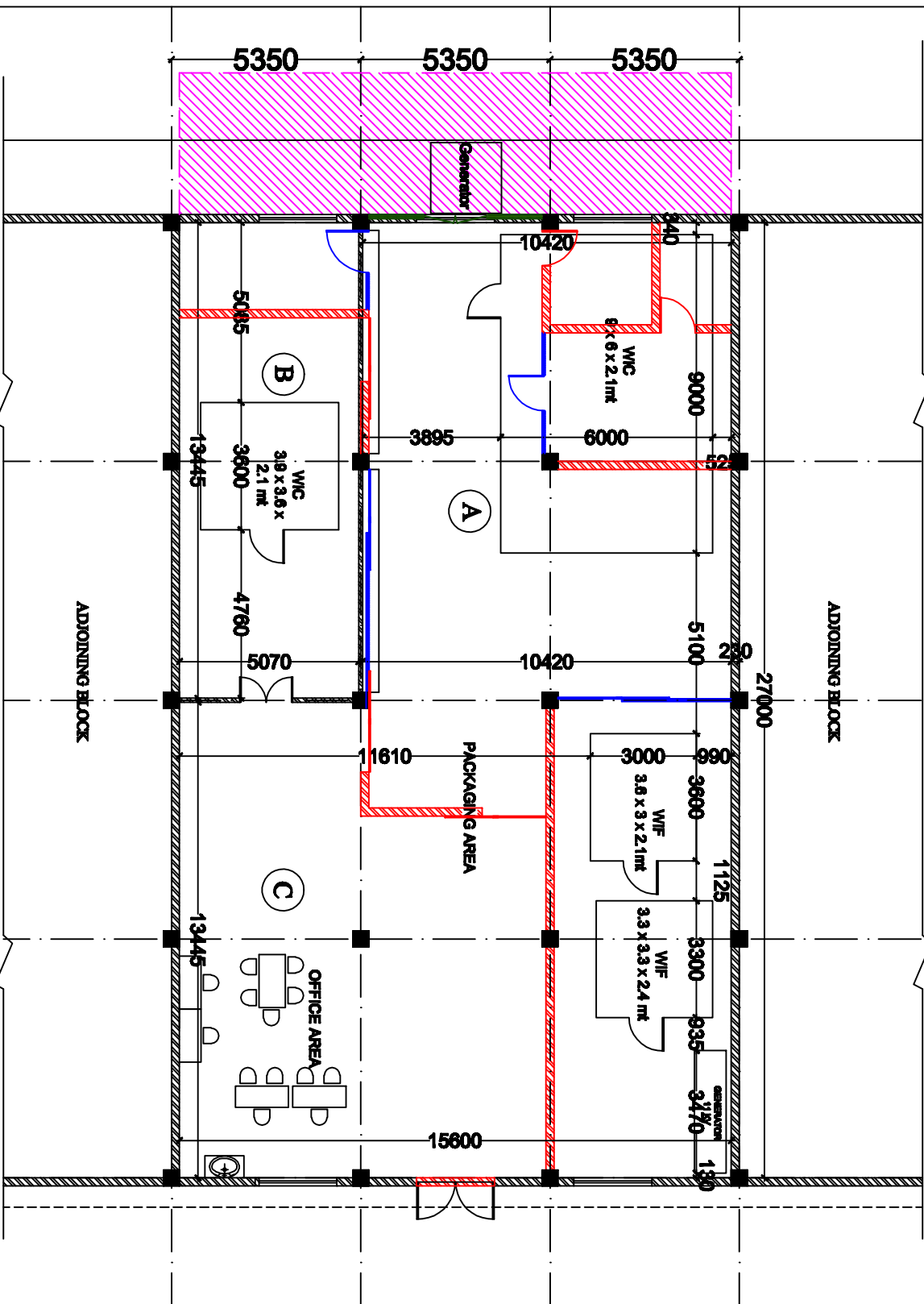

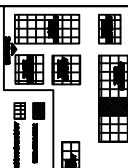

**GMSD - MUMBAI**

DRAWING

KEY PLAN



LEGEND

- | | |
|---|--|
|  | REINFORCED WALLS WITH CRACKS |
|  | REINFORCED PARTITION WALLS WITH CRACKS |
|  | REINFORCED CRACKS IN EXISTING WALLS |
|  | REINFORCED CAVITY |

10

1. This drawing is simple.
2. This drawing stands on its own without the need for any other drawings.
3. The cost will be less than the design.
4. All drawings are for the same reason: to sell.
5. These drawings are my father-in-law's idea.
6. The drawings are for the same reason: to sell.
7. The drawings are my father-in-law's idea.

DATA	SYSTEM (READ OR WRITE)	DATE
1		
2		
3	FOR TOWER	5-20-63
4	RECORD NO. (READ OR WRITE)	DATE

**REGISTRATION OF COMPANY
INFORMATION IN THE COMPANY
INVESTMENT BOARD. BOARD OF
DIRECTORS. BOARD OF DIRECTORS
INVESTMENT BOARD. BOARD OF
DIRECTORS. BOARD OF DIRECTORS**

EXISTING FLOOR PLAN WITH PROPOSED WALLS & PARTITIONS (MILWAUKEE)	DATE JAN 7/2008
---	--------------------

AR	CASE NO.: 08-00275/MS-90661
----	-----------------------------

BLUNDER SAWHNEY ASSOCIATES
ARCHITECTS & INTERIOR DESIGNERS
6 ST. SECTORS-A, DALLAS
E-MAIL: info@blunder.com
PHONE: 214.761.1111